

TMF Series – Low Wattage LED Flood

Seeking an Ultra-long Life Energy Efficient Lighting Solution?

- As LED efficacies climb and costs begin to descend, LED is becoming viable in more and more general lighting applications.
- Many low wattage spot, flood, security, and accent applications can benefit from the directional characteristics of LED.
- Amazingly, a single TMF LED flood replaces ground mounted 150-250 watt HID flagpole floods, sign lighters, and palm floods with ease.

Why P2? It's Simple. Our Experience.

- Properly deployed, and aimed at commercially viable applications, LED is a valuable light source.
- Improperly deployed on your project, it can be a nightmare that damages your credibility with your customer.
- Anyone can adapt LED to existing fixture bodies. Many have created LED light sources that mimic legacy products but fail to deliver comparable performance.
- It takes a real expert to combine LED technology with proper lighting fundamentals and commercially viable applications.
- Our engineers have the tools and expertise to thermally and photometrically model your system to ensure that the long life and performance promised by LED is delivered.

Long Life, Low Watt LED Flood Light



Application

- Building Signage
- Flagpoles
- Palm Trees
- Wall Wash
- Utility Spot
- Utility Flood
- Accent
- Security

TMF - 21W - MF - TG - 50K - 18C - UL - 350 - YC - BB

TMF	21W	MF	TG	50K	18C	UL	350	YC	BB
Fixture Series	Input Watts	Primary Optics	Secondary Optics	Color Temp	LED Chip Quantity	Voltage	Drive Current	Mounting	Fixture Finish

Fixture Series
TMF = LED Flood Light

Input Watts
14W = 14 Watt (12 Chip, 350mA)
16W = 16 Watt (6 Chip, 700mA)
21W = 21 Watt (18 Chip, 350mA)
21W = 21 Watt (12 Chip, 520mA)

Primary Optics
SP = 12° Spot (Standard)
MF = 25° Flood
DSP = 32° Diffused Flood

Secondary Optics
TG = Clear Tempered Glass Lens (STD)
CP = Clear Polycarb Lens
HF = Horizontal Flood Linear Refractor

Color Temperature
50K = 5000 Kelvin

Qty of LED Chips
6C = 6 Chip Board
12C = 12 Chip Board
18C = 18 Chip Board

Voltage
UL = 120 through 277 volt

Drive Current
350 = 350 mA Across Chip
520 = 520 mA Across Chip*
700 = 700 mA Across Chip**

* Available only with 21W/12C
** Available only with 16W/6C

Mounting
YM = Yoke Mount Only w/18" Cord
YC = Yoke Mount with WCA Cover Plate Assembly

Other Accessories Ordered Separately
AJ = Architectural Junction Box
BX = Brass In-grade Junction Box
WCA = Two Piece Wall/Ceiling Adaptor
GS = Ground Stake
PA = Cast Post Top Adaptor
TS = Tree Strap
12NA = 1/2" Water Tight NPT Adaptor
34NA = 3/4" Water Tight NPT Adaptor

Fixture Finish
BB = Black
BW = White
BZ = Bronze
RAL = RALxxxx (RAL Specification)

TMF Series – Low Wattage LED Flood

YC = Yoke Mount with complete WCA Adaptor Assembly



Wall Mount

- Utility Flood
- Utility Spot
- Accent
- Security



Ground Mount

- Building Signage
- Flagpoles
- Palm Trees
- Landscape
- Wall Wash

Fixture Construction

- Die cast aluminum body designed for maximum heat dissipation.
- Designed to meet IP66 standards.
- Sealed tempered glass lens.
- Stainless steel fasteners.
- Dedicated constant current driver.
- Advanced thermal management techniques and components.

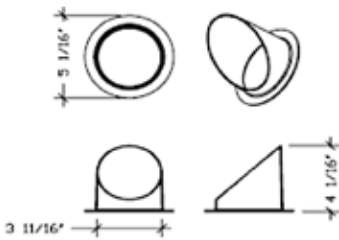

VS = Visor

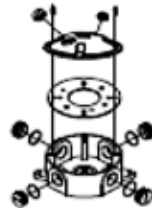

AJ = Architectural J-Box

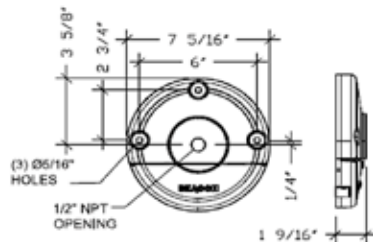
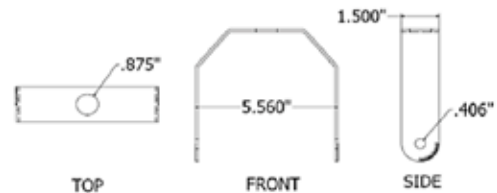
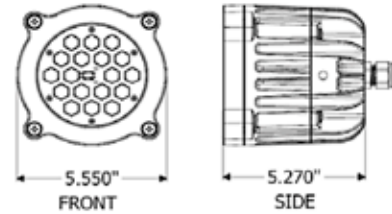

WCA = Two Piece Wall/Ceiling Adaptor

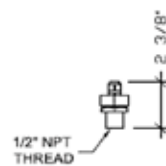

12NA = Aluminum/Brass Water Tight NPT Adaptor

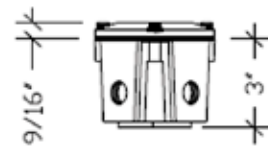
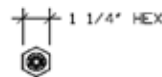

BX = Brass In-grade Junction Box

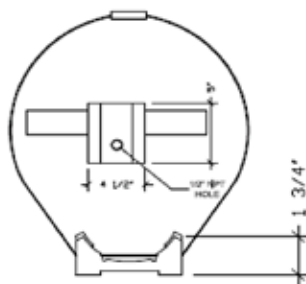

TS = Tree Strap

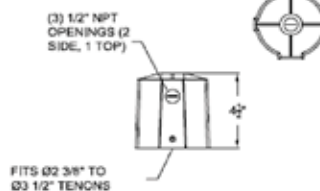

PA = Cast Post Top Adaptor

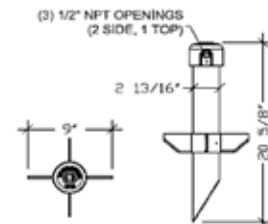

GS = Ground Stake